

508-010-01  
UNITED STATES OF AMERICA

083-440-73  
PRICE FAMILY  
2019 TRUST

S87°27'14"E 1357.62'

WASHOE COUNTY

CITY OF SPARKS

508-460-01  
HIGHLAND RANCH HOA

N02°08'36"E 1139.67'

LOT 1  
SECTION 8  
T20N, R20E, MDM  
APN: 508-020-01  
±34.71 ACRES

S03°15'46"W 1105.50'

N88°55'18"W 1336.22'

508-350-01  
HIGHLAND RANCH HOA

083-011-15  
QK, LLC

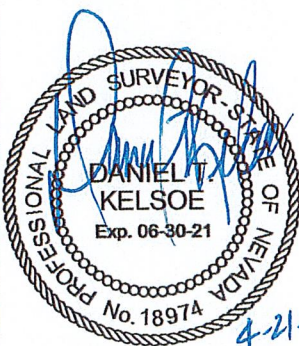

SCALE: 1"=300'

WASHOE COUNTY  
CITY OF SPARKS

ANNEXATION EXHIBIT

2346 DONATELLO DRIVE  
WASHOE COUNTY, NEVADA 89433  
APN: 508-020-01



1000 Kiley Pkwy | Sparks Nevada 89436

775.502.8552 christynv.com